



SECTION CONTENTS

ASSORTMENT/MOUNT KITS

Clear Hole.....	79
Threaded.....	79
Metric.....	79
Nylon support	79
PC-104	70

MOLDED PC SPACERS

Adhesive.....	78
Lock in - Lock in.....	76-78
Lock in - Releasable.....	76-78
Releasable.....	76-78
Support.....	78
Threaded.....	77

SPACERS

Clear Hole.....	74
Economy (Rolled).....	74
Retaining Spacer.....	75
Swage / Force Fit.....	73
Stacking.....	77

THREADED STANDOFFS

Ceramic.....	74
Female-Female.....	70
Hinged.....	75
Male-Female.....	70
Metric.....	72
Swage / Force Fit.....	73

MALE/FEMALE THREADED STANDOFFS

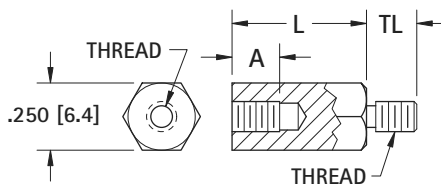

THREAD SIZE	TL EXTERNAL	A INTERNAL
4-40	.187 (4.7)	.250 (6.4)
6-32	.250 (6.4)	.375 (9.5)
8-32	.375 (9.5)	.375 (9.5)

Application Note:
For PC/104 applications use length .600 (15.3) 4-40 Thread

CHOICE OF:		
Stainless: ASTM A581/A582	Brass: ASTM-B16 Plating: Nickel (QQ-N-290)	Aluminum: RoHS Compliant Plating: Clear Iridite (Mil-C-5541)

4-40 THREAD			
L LENGTH	STAINLESS STEEL CAT NO.	BRASS CAT NO.	ALUMINUM CAT NO.
.250 (6.4)***	8712	8713	8714
.375 (9.5)	2087	7200	8400
.500 (12.7)	2088	1944	8401
.600 (15.2)*	5799	8799	6799
.625 (15.9)	2089	1945	8402
.750 (19.1)	2090	1946	8403
.875 (22.2)	2091	7201	8404
1.000 (25.4)	2092	1947	8405
1.125 (28.6)	2093	7202	8406
1.250 (31.8)	2094	1948	8407
1.375 (34.9)	2095	1949	8408
1.500 (38.1)	2096	1950	8409
1.625 (41.3)	2097	7203	8410
1.750 (44.5)	2098	7205	8411
2.000 (50.8)	2099	1951	8412

*PC/104 Standard Length
***Internal Thread .130 (3.3)/.150 (3.8) Deep

6-32 THREAD			
L LENGTH	STAINLESS STEEL CAT NO.	BRASS CAT NO.	ALUMINUM CAT NO.
.250 (6.4)***	8715	8716	8717
.375 (9.5)**	2119	7210	8413
.500 (12.7)	2120	1952	8414
.625 (15.9)	2121	1953	8415
.750 (19.1)	2122	1954	8416
.875 (22.2)	2123	7211	8417
1.000 (25.4)	2124	1644	8418
1.125 (28.6)	2125	7212	8419
1.250 (31.8)	2126	1955	8420
1.375 (34.9)	2127	1956	8421
1.500 (38.1)	2128	1645	8422
1.625 (41.3)	2129	7214	8423
1.750 (44.5)	2130	7215	8424
2.000 (50.8)	2131	1646	8425

** Internal Thread .250 (6.4) Deep
*** Internal Thread .130 (3.3)/.150 (3.8) Deep

8-32 THREAD			
L LENGTH	STAINLESS STEEL CAT NO.	BRASS CAT NO.	ALUMINUM CAT NO.
.250 (6.4)***	8731	8732	8733
.375 (9.5)**	2149	7220	8426
.500 (12.7)	2150	1957	8427
.625 (15.9)	2151	1958	8428
.750 (19.1)	2152	1959	8429
.875 (22.2)	2153	7221	8430
1.000 (25.4)	2154	1960	8431
1.125 (28.6)	2155	7222	8432
1.250 (31.8)	2156	1961	8433
1.375 (34.9)	2157	1962	8434
1.500 (38.1)	2158	1963	8435
1.625 (41.3)	2159	7224	8436
1.750 (44.5)	2160	7225	8437
2.000 (50.8)	2161	1964	8438
2.500 (63.5)	2180	1965	8439
3.000 (76.2)	2181	1966	8440

** Internal Thread .250 (6.4) Deep
*** Internal Thread .130 (3.3)/.150 (3.8) Deep

PC 104 MOUNTING KITS

- Designed to ease the assembly of new modules and multi-board stacks.
- Each kit includes all the hardware that is required to mount a single-board.

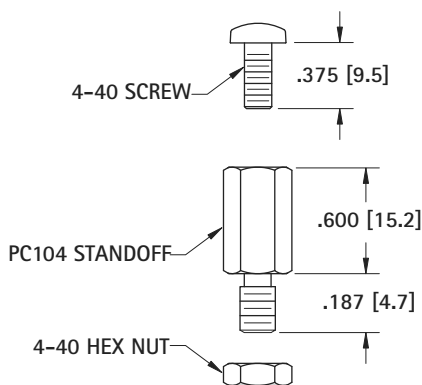

Complete Kit CAT. NO.	Kit Description	Includes Four (4) each:		
		Standoff	Screw	Nut
4799-4	Nylon	4799	9328	9605
5799-4	Stainless Steel	5799	9901	7248-3
6799-4	Aluminum	6799	9301*	9600*
8799-4	Brass	8799	9301*	9600*

* Aluminum and brass kits supplied with steel hardware.

NYLON STANDOFFS

MATERIAL: Nylon 6/6

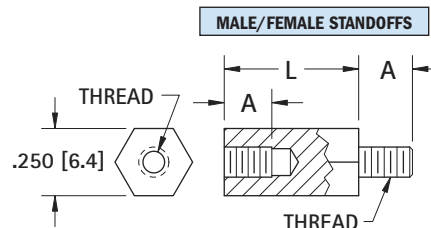

L LENGTH	THREAD SIZE		
	4-40 CAT. NO.	6-32 CAT. NO.	8-32 CAT. NO.
.250 (6.4)***	4800	4814	4828
.375 (9.5)	4801	4815	4829**
.500 (12.7)	4802	4816	4830
.600 (15.2)*	4799	-	-
.625 (15.9)	4803	4817	4831
.750 (19.1)	4804	4818	4832
.875 (22.2)	4805	4819	4833
1.000 (25.4)	4806	4820	4834
1.125 (28.6)	4807	4821	4835
1.250 (31.8)	4808	4822	4836
1.375 (34.9)	4809	4823	4837
1.500 (38.1)	4810	4824	4838
1.625 (41.3)	4811	4825	4839
1.750 (44.5)	4812	4826	4840
2.000 (50.8)	4813	4827	4841

* PC/104 Standard Length
** Internal Thread .250 (6.4) Deep
*** Internal Thread .130 (3.3)/.150 (3.8) Deep



Application Note:
For PC/104 applications use CAT. NO. 4799

THREAD SIZE	A
4-40	.187 (4.7)
6-32	.250 (6.4)
8-32	.375 (9.5)

HEX MALE/FEMALE STANDOFFS

FEMALE THREADED STANDOFFS

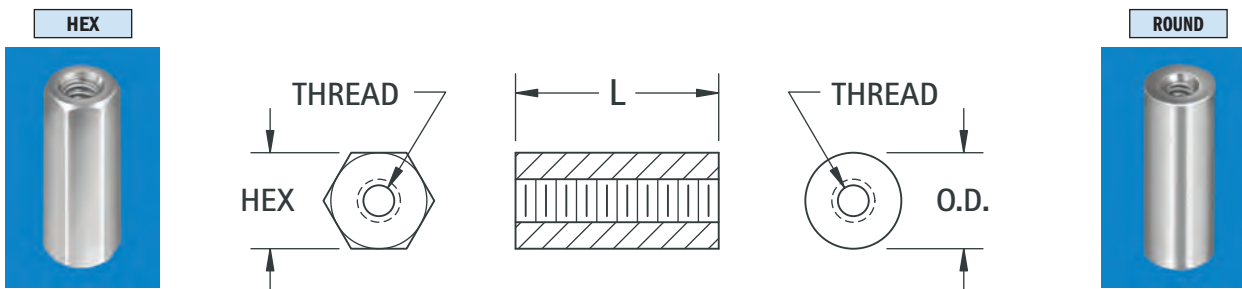

CHOICE OF:				
Stainless: ASTM A581/A582	Brass: per ASTM-B16 Plating: Zinc ASTM B633	Aluminum: ASTM B211 Plating: Clear Iridite Finish	Nylon V2: 6/6 UL Rated 94V-2 Nylon V0: 6/6 UL Rated 94V-0	Phenolic: PBE Grade Natural Color Phenolic

HEX	HEX					LENGTH	ROUND			O.D.
	NYLON V2 CAT. NO.	NYLON V0 CAT. NO.	STAINLESS CAT. NO.	BRASS CAT. NO.	ALUMINUM CAT. NO.		BRASS CAT. NO.	ALUMINUM CAT. NO.	PHENOLIC CAT. NO.	
2-56 THREAD										
.156 (3.9)	—	—	—	1798A	1797A	.187 (4.7)	1802A	1801A	—	.156 (3.9)
	—	—	—	1798B	1797B	.250 (6.4)	1802B	1801B	—	
	—	—	—	1798C	1797C	.312 (7.9)	1802C	1801C	—	
	—	—	—	1798D	1797D	.375 (9.5)	1802D	1801D	—	
4-40 THREAD										
.187 (4.7)	—	—	—	1450	1891	.250 (6.4)	1547	2025	—	.187 (4.7)
	—	—	—	1803	1892	.375 (9.5)	1864	2026	—	
	—	—	—	1656	1893	.500 (12.7)	1657	2027	—	
	—	—	—	1804	1894	.625 (15.9)	1865	2028	—	
	—	—	—	1656A	1895	.750 (19.1)	1657A	2029	—	
	—	—	—	1805	1896	.875 (22.2)	1866	2030	—	
.250 (6.3)	—	—	—	1656B	1897	1.000 (25.4)	1657B	2031	—	.250 (6.3)
	1902A	8440A	1921	1450A	2201	.250 (6.4)	1547A	3478	376	
	1902B	8440B	1921A	1450B	2202	.375 (9.5)	1547B	3479	377	
	1902C	8440C	1921B	1450C	2203	.500 (12.7)	1547C	3480	378	
	1902F	8440D	—	1829	1808	.625 (15.9)	1867	1839	—	
	1902D	8440E	1921C	1450D	2204	.750 (19.1)	1547D	3481	379	
	1902G	8440F	—	1830	1809	.875 (22.2)	1876	1846	—	
	1902E	8440G	1921D	1450E	2205	1.000 (25.4)	1547E	3482	380	
—	—	1921E	1831	2206	1.500 (38.1)	1877	3483	381		
—	—	1921F	1832	2207	2.000 (50.8)	1878	3484	382		
6-32 THREAD										
.250 (6.3)	1903A	8441A	1922	1451A	2208	.250 (6.4)	1548A	3485	383	.250 (6.3)
	1903B	8441B	1922A	1451B	2209	.375 (9.5)	1548B	3486	384	
	1903C	8441C	1922B	1451C	2210	.500 (12.7)	1548C	3487	385	
	1903F	8441D	—	1451D	1813	.625 (15.9)	1548D	1847	—	
	1903D	8441E	1922C	1451E	2211	.750 (19.1)	1548E	3488	386	
	1903G	8441F	—	1833	1816	.875 (22.2)	1879	1848	—	
	1903E	8441G	1922D	1635	2212	1.000 (25.4)	1548F	3489	387	
	—	—	—	1636	1818	1.250 (31.8)	1881	1853	—	
	—	—	1922E	1637	2213	1.500 (38.1)	1882	3490	388	
	—	—	—	1638	1819	1.750 (44.5)	1883	1855	—	
	—	—	1922F	1639	2214	2.000 (50.8)	1884	3491	389	
	—	—	—	1642	1820	2.250 (57.2)	1885	1856	—	
	—	—	—	1643	1825	2.500 (63.5)	1886	1857	—	
	8-32 THREAD									
.250 (6.3)	1904A	8442A	1923	1474A	2215	.250 (6.4)	1692A	3492	390	.250 (6.3)
	1904B	8442B	1923A	1474B	2216	.375 (9.5)	1692B	3493	391	
	1904C	8442C	1923B	1474C	2217	.500 (12.7)	1692C	3494	392	
	1904F	8442D	—	1834	1827	.625 (15.9)	1887	1858	—	
	1904D	8442E	1923C	1474D	2218	.750 (19.1)	1692D	3495	393	
	1904G	8442F	—	1836	1828	.875 (22.2)	1888	1859	—	
	1904E	8442G	1923D	1474E	2219	1.000 (25.4)	1692E	3496	394	
	—	—	1923E	1837	2220	1.500 (38.1)	1889	3497	395	
	—	—	1923F	1838	2221	2.000 (50.8)	1899	3498	396	
10-32 THREAD										
.312 (7.9)	—	—	1475A	1822A	1821A	.375 (9.5)	3499A	3500A	468	.312 (7.9)
	—	—	1475B	1822B	1821B	.500 (12.7)	3499B	3500B	469	
	—	—	1475C	1822C	1821C	.625 (15.9)	3499C	3500C	—	
	—	—	1475D	1822D	1821D	.750 (19.1)	3499D	3500D	470	
	—	—	1475F	1822F	1821F	1.000 (25.4)	3499F	3500F	471	

NOTE: All standoffs over 1.000 (25.4) are tapped .375 (9.5) min. both ends, except 4-40 standoffs which are tapped .250 (6.4) min.

METRIC STANDOFFS

MALE/FEMALE



FEMALE



THREAD SIZE	TL	A
M2.5	4.0	5.0
M3	8.0	8.0
M4	10.0	11.0

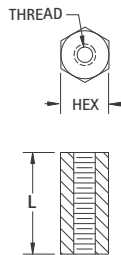
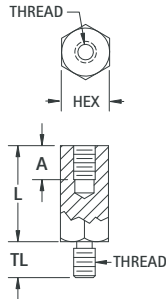

CHOICE OF:

Stainless: ASTM A581/A582

Brass: ASTM-B16
Plating: Nickel (QQ-N-290)

Aluminum: QQ-Q-225/3
Plating: Clear Iridite (Mil-C-5541)

MALE/FEMALE				FEMALE		
STAINLESS CAT. NO.	BRASS CAT. NO.	ALUMINUM CAT. NO.	L	STAINLESS CAT. NO.	BRASS CAT. NO.	ALUMINUM CAT. NO.
4.5 HEX DIA. (M2.5 THREAD)						
—	—	—	5.0	24460	24380	24420
—	—	—	6.0	24461	24381	24421
—	—	—	8.0	24462	24382	24422
24283	24307	24331	10.0	24463	24383	24423
24284	24308	24332	12.0	24464	24384	24424
24285	24309	24333	15.0	24465	24385	24425
24286	24310	24334	18.0	24466	24386	24426
24287	24311	24335	20.0	24467	24387	24427
24288	24312	24336	25.0	24468	24388	24428
5.0 HEX DIA. (M3 THREAD)						
—	—	—	5.0	24470	24390	24430
—	—	—	6.0	24471	24391	24431
—	—	—	8.0	24472	24392	24432
24289	24313	24337	10.0	24473	24393	24433
24290	24314	24338	12.0	24474	24394	24434
24291	24315	24339	15.0	24475	24395	24435
24292	24316	24340	18.0	24476	24396	24436
24293	24317	24341	20.0	24477	24397	24437
24294	24318	24342	25.0	24478	24398	24438
5.5 HEX DIA. (M3 THREAD)						
—	—	—	5.0	24480	24400	24440
—	—	—	6.0	24481	24401	24441
—	—	—	8.0	24482	24402	24442
24295	24319	24343	10.0	24483	24403	24443
24296	24320	24344	12.0	24484	24404	24444
24297	24321	24345	15.0	24485	24405	24445
24298	24322	24346	18.0	24486	24406	24446
24299	24323	24347	20.0	24487	24407	24447
24300	24324	24348	25.0	24488	24408	24448
6.0 HEX DIA. (M4 THREAD)						
—	—	—	5.0	24490	24410	24450
—	—	—	6.0	24491	24411	24451
—	—	—	8.0	24492	24412	24452
24301**	24325**	24349**	10.0	24493	24413	24453
24302*	24326*	24350*	12.0	24494	24414	24454
24303	24327	24351	15.0	24495	24415	24455
24304	24328	24352	18.0	24496	24416	24456
24305	24329	24353	20.0	24497	24417	24457
24306	24330	24354	25.0	24498	24418	24458

* Internal Thread: 8.0mm deep ** Internal Thread: 6.0mm deep
Note: Female standoffs longer than 19mm may be tapped from both ends

METRIC NYLON STANDOFFS

Material: Nylon: 6/6, UL Rated 94V-2

MALE/FEMALE



FEMALE

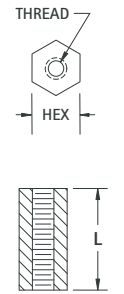
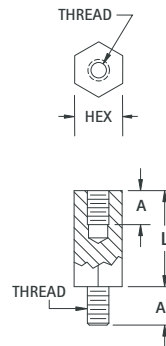

MALE/FEMALE CAT. NO.	L	FEMALE CAT. NO.
5.0 HEX (M3 THREAD)		
—	6.0	25508
—	8.0	25509
25501	10.0	25510
25502	12.0	25511
25503	15.0	25512
25504	18.0	25513
25505	20.0	25514
25506	25.0	25515
5.5 HEX (M4 THREAD)		
—	6.0	25528
—	8.0	25529
25521	10.0	25530
25522	12.0	25531
25523	15.0	25532
25524	18.0	25533
25525	20.0	25534
25526	25.0	25535

Note: Female standoffs longer than 19mm may be tapped from both ends

METRIC NYLON LOCK-IN SUPPORT

- One end locks into chassis, the other end locks into the PC Board.

4.00 mm

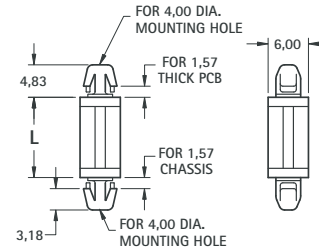

CAT. NO.	L DIM
8843	3.0
8844	4.0
8845	6.0
8846	8.0
8847	10.0
8848	12.0
8849	14.0
8850	16.0
8851	18.0

Material: Nylon 6/6, UL Rated 94V-2

METRIC SCREWS

Choice of: Steel, Zinc Plate • Nylon: 6/6, UL Rated 94V-2

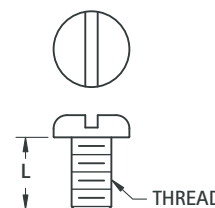

STEEL CAT. NO.	L	NYLON 6/6 CAT. NO.
M2.5 THREAD		
29301	6.00	29331
29304	12.00	29334
29306	16.00	29336
M3 THREAD		
29311	6.00	29341
29314	12.00	29344
29316	16.00	29346
29318	25.00	29348
M4 THREAD		
29321	6.00	29351
29324	12.00	29354
29326	16.00	29356
29328	25.00	29358

SWAGE THREADED STANDOFFS

ROUND

HEX

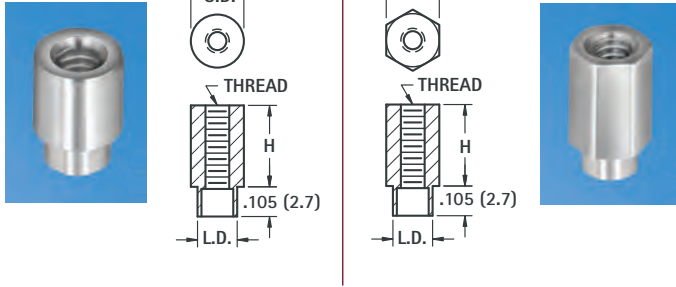

MATERIAL: Brass, ASTM-B16, Nickel Plate (QQ-N-290)
For .062 (1.52) thick boards

ROUND CAT. NO.	H HEIGHT ABOVE PANEL	L.D. SHANK DIAMETER	HEX CAT. NO.
2-56 THREAD × .156 (4.0) O.D.			
1589-2	.125 (3.2)	.125 (3.2)	1731-2
1590-2	.187 (4.7)	.125 (3.2)	1734-2
1591-2	.250 (6.4)	.125 (3.2)	1740-2
1596-2	.375 (9.5)	.125 (3.2)	1743-2
4-40 THREAD × .187 (4.7) O.D.			
2260-2	.125 (3.2)	.139 (3.5)	2270-2
2261-2	.187 (4.7)	.139 (3.5)	2271-2
2262-2	.250 (6.4)	.139 (3.5)	2272-2
2263-2	.375 (9.5)	.139 (3.5)	2273-2
2264-2	.500 (12.7)	.139 (3.5)	2274-2
4-40 THREAD × .250 (6.4) O.D.			
1560A	.125 (3.2)	.187 (4.7)	1653-2
1790-2	.187 (4.7)	.187 (4.7)	1746-2
1650-2	.250 (6.4)	.187 (4.7)	1627-2
1651-2	.375 (9.5)	.187 (4.7)	1628-2
1623-2	.500 (12.7)	.187 (4.7)	1629-2
1624-2	.625 (15.9)	.187 (4.7)	1654-2
1625-2	.750 (19.1)	.187 (4.7)	1655-2
1792-2	.875 (22.2)	.187 (4.7)	1749-2
1652-2	1.000 (25.4)	.187 (4.7)	1630-2
6-32 THREAD × .250 (6.4) O.D.			
1560B	.125 (3.2)	.187 (4.7)	1620-2
1612-2	.187 (4.7)	.187 (4.7)	1752-2
1546	.250 (6.4)	.187 (4.7)	1621-2
1561B	.375 (9.5)	.187 (4.7)	1622-2
1604-2	.500 (12.7)	.187 (4.7)	1758-2
1605-2	.625 (15.9)	.187 (4.7)	1759-2
1608-2	.750 (19.1)	.187 (4.7)	1761-2
1796-2	.875 (22.2)	.187 (4.7)	1775-2
1609-2	1.000 (25.4)	.187 (4.7)	1784-2

SWAGE CLEAR HOLE SPACERS

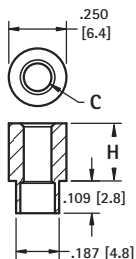

CAT. NO.	H HEIGHT ABOVE PANEL	C HOLE
5058-2	.125 (3.2)	.120 (3.0) For # 4
5060-2	.250 (6.4)	
5061-2	.375 (9.5)	
5062-2	.500 (12.7)	
5059-2	.125 (3.2)	.140 (3.5) For # 6
5063-2	.250 (6.4)	
5064-2	.375 (9.5)	
5065-2	.500 (12.7)	

MATERIAL: Brass, ASTM-B16, Nickel Plate (QQ-N-290)
For .062 (1.52) thick boards

FORCE-FIT STANDOFFS

ROUND

A broaching-type fastener/standoff for installation in panels and circuit boards .060 (1.52) and thicker made of plastic and other non-ductile materials. Available threaded or with clearance holes. Easy to install, presses into punched or drilled holes.

MATERIAL: Stainless Steel per ASTM-A581/A582

MOUNTING HOLES:

- .147 (3.7) hole for 2-56
- .166 (4.2) hole for 4-40
- .213 (5.4) hole for 6-32

TOLERANCE ON MOUNTING HOLES:

+ .003 / - .000

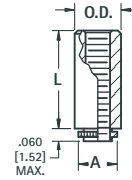

Threaded

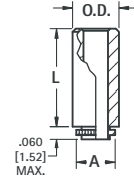

Clear Hole

THREADED				
CAT. NO.	L LENGTH	O.D.	A	THREAD
4860	.065 (1.7)	.219 (5.6)	.165 (4.2)	2-56
4861	.065 (1.7)	.219 (5.6)	.184 (4.7)	4-40
4862	.125 (3.2)	.219 (5.6)	.184 (4.7)	
4863	.250 (6.4)	.219 (5.6)	.184 (4.7)	
4864	.375 (9.5)	.219 (5.6)	.184 (4.7)	
4865 *	.500 (12.7)	.219 (5.6)	.184 (4.7)	
4866	.065 (1.7)	.281 (7.1)	.231 (5.9)	6-32
4867	.125 (3.2)	.281 (7.1)	.231 (5.9)	
4868	.250 (6.4)	.281 (7.1)	.231 (5.9)	
4869	.375 (9.5)	.281 (7.1)	.231 (5.9)	
4870 *	.500 (12.7)	.281 (7.1)	.231 (5.9)	

*Thread depth .375 (9.5)

CLEAR HOLE				
CAT. NO.	L LENGTH	O.D.	A	HOLE
4850	.065 (1.7)	.219 (5.6)	.184 (4.7)	.116 (2.9) For # 4
4851	.125 (3.2)	.219 (5.6)	.184 (4.7)	
4852	.250 (6.4)	.219 (5.6)	.184 (4.7)	
4853	.375 (9.5)	.219 (5.6)	.184 (4.7)	
4854	.500 (12.7)	.219 (5.6)	.184 (4.7)	.143 (3.6) For # 6
4855	.065 (1.7)	.281 (7.1)	.231 (5.9)	
4856	.125 (3.2)	.281 (7.1)	.231 (5.9)	
4857	.250 (6.4)	.281 (7.1)	.231 (5.9)	
4858	.375 (9.5)	.281 (7.1)	.231 (5.9)	
4859	.500 (12.7)	.281 (7.1)	.231 (5.9)	

SWAGE STAKING TOOLS

Precision made staking tool kits are made from .250 (6.4) diameter heat treated steel, zinc plated. Each kit includes the correct swage top staking tool anvil to create a professional appearance. These tools may be used with an arbor press or hand tapped.

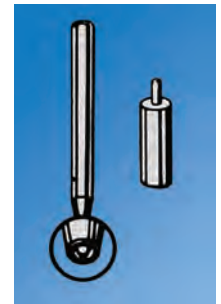

CAT. NO.	STANDOFF DIA.	THREAD	HOLE SIZE
TL-19	.156 (4.0)	2-56	-
TL-22	.187 (4.7)	4-40	-
TL-20	.250 (6.4)	4-40	.120 (3.0)
TL-21	.250 (6.4)	6-32	.140 (3.5)

ROUND CLEAR HOLE SPACERS

CLEAR HOLE	O.D.	L LENGTH	BRASS CAT. NO.	ALUMINUM CAT. NO.
.120 (3.0) For #4	.250 (6.4)	.125 (3.2)	1909	2036
		.250 (6.4)	1454A	3457
		.375 (9.5)	1454B	3458
		.500 (12.7)	1454C	3459
		.625 (15.9)	1919	2314
		.750 (19.1)	1454D	3460
		.875 (22.2)	1920	3402
		1.000 (25.4)	1454E	3461
		1.500 (38.1)	1924	3462
		2.000 (50.8)	1925	3463
.140 (3.5) For #6	.250 (6.4)	.125 (3.2)	1934	3403
		.250 (6.4)	1457A	3464
		.375 (9.5)	1457B	3465
		.500 (12.7)	1457C	3466
		.625 (15.9)	1935	3429
		.750 (19.1)	1457D	3467
		.875 (22.2)	1936	3438
		1.000 (25.4)	1457E	3468
		1.500 (38.1)	1937	3469
		2.000 (50.8)	1938	3470
.171 (4.3) For #8	.250 (6.4)	.125 (3.2)	1942	4258
		.250 (6.4)	1480	3471
		.375 (9.5)	1481	3472
		.500 (12.7)	1482	3473
		.625 (15.9)	2032	4259
		.750 (19.1)	1483	3474
		.875 (22.2)	2033	4260
		1.000 (25.4)	1484	3475
		1.500 (38.1)	2034	3476
		2.000 (50.8)	2035	3477
.196 (5.0) For #10	.312 (7.9)	.250 (6.4)	1662	4261
		.375 (9.5)	1663	4262
		.500 (12.7)	1664	4263
		.625 (15.9)	1665	4264
		.750 (19.1)	1666	4265
		.875 (22.2)	1667	4266
		1.000 (25.4)	1668	4267
		1.500 (38.1)	1669	4268
2.000 (50.8)	1672	4269		

MATERIAL:

Brass: ASTM-B16, Nickel Plate (QQ-N-290)
 Aluminum: ASTM B211, Clear Iridite (MIL-C-5541)
 Nylon: Nylon 6/6, UL Rated 94V-2
 Phenolic: PBE Grade Natural Color Phenolic

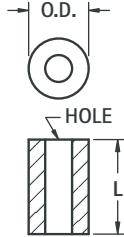
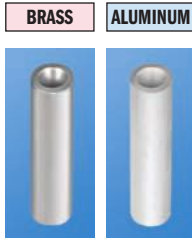

NYLON CAT. NO.	PHENOLIC CAT. NO.	L LENGTH	O.D.	CLEAR HOLE
875	—	.125 (3.2)	.250 (6.4)	.120 (3.0) For #4
876	360	.250 (6.4)		
877	361	.375 (9.5)		
878	362	.500 (12.7)		
879	—	.625 (15.9)		
880	363	.750 (19.1)		
881	—	.875 (22.2)		
882	364	1.000 (25.4)		
779	365	1.500 (38.1)		
—	366	2.000 (50.8)		
883	—	.125 (3.2)	.250 (6.4)	.140 (3.5) For #6
884	367	.250 (6.4)		
885	368	.375 (9.5)		
886	369	.500 (12.7)		
887	—	.625 (15.9)		
888	370	.750 (19.1)		
889	—	.875 (22.2)		
890	371	1.000 (25.4)		
789	372	1.500 (38.1)		
—	373	2.000 (50.8)		
891	—	.125 (3.2)	.250 (6.4)	.171 (4.3) For #8
892	1490	.250 (6.4)		
893	1491	.375 (9.5)		
894	1492	.500 (12.7)		
895	—	.625 (15.9)		
896	1493	.750 (19.1)		
897	—	.875 (22.2)		
898	1494	1.000 (25.4)		
799	374	1.500 (38.1)		
—	375	2.000 (50.8)		
790	453	.250 (6.4)	.312 (7.9)	.196 (5.0) For #10
791	454	.375 (9.5)		
792	455	.500 (12.7)		
793	—	.625 (15.9)		
794	456	.750 (19.1)		
795	—	.875 (22.2)		
796	457	1.000 (25.4)		
797	458	1.500 (38.1)		
—	459	2.000 (50.8)		

ALUMINUM ECONOMY SPACERS

- Made of flat strip aluminum and rolled on precision equipment.
- Assures maximum bearing surface, square ends.

Aluminum:

5052-H34 per QQ-A-250/8b

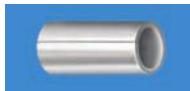

Tight Joint on Outside Diameter

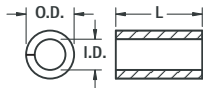

SPACER FOR	I.D.	O.D. REF.
# 4	.120 (3.0)	.167 (4.3)
# 6	.148 (3.8)	.193 (4.9)
# 8	.176 (4.5)	.232 (5.9)

L LENGTH	SCREW CLEARANCE		
	# 4 CAT. NO.	# 6 CAT. NO.	# 8 CAT. NO.
.187 (4.7)	397	—	—
.250 (6.4)	398	405	412
.312 (7.9)	399	406	413
.375 (9.5)	400	407	414
.437 (11.1)	401	408	415
.500 (12.7)	402	409	416
.625 (15.9)	403	410	417

L LENGTH	SCREW CLEARANCE		
	# 4 CAT. NO.	# 6 CAT. NO.	# 8 CAT. NO.
.750 (19.1)	418	425	432
.875 (22.2)	419	426	433
1.000 (25.4)	420	427	434
1.250 (31.8)	421	428	435
1.500 (38.1)	422	429	436
1.750 (44.5)	—	430	437
2.000 (50.8)	—	—	438

CERAMIC STANDOFFS

- Ideal for very high temperature conditions
- Commercial and military types available
- Military types meet MIL-1-010, NL # clearly marked
- Exceptional strength in compression and tension
- Withstands very high voltage without flashover
- Special sizes available upon request

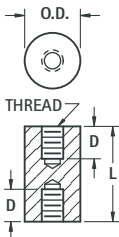

MATERIAL: Grade L5 Ceramic

CAT. NO.	L LENGTH	O.D.	COMMERCIAL	
			T THREAD	D DEPTH
7710	.250 (6.4)	.250 (6.4)	6-32	THRU
7711	.500 (12.7)	.250 (6.4)	6-32	.156 (4.0)
7712	.375 (9.5)	.375 (9.5)	6-32	.156 (4.0)
7713	.500 (12.7)	.375 (9.5)	6-32	.156 (4.0)
7714	.500 (12.7)	.500 (12.7)	6-32	.140 (3.6)
7715	.750 (19.1)	.500 (12.7)	6-32	.250 (6.4)
7716	1.000 (25.4)	.500 (12.7)	6-32	.375 (9.5)
7717	1.500 (38.1)	.500 (12.7)	6-32	.562 (14.3)
7718	2.500 (63.5)	.500 (12.7)	6-32	.500 (12.7)
7719	2.500 (63.5)	.750 (19.1)	1/4 - 20	.750 (19.1)
7720	4.000 (101.6)	.750 (19.1)	1/4 - 20	.750 (19.1)

MILITARY

CAT. NO.	L LENGTH	O.D.	T THREAD	D DEPTH	NL #
7661	.500 (12.7)	.375 (9.5)	6-32	.156 (4.0)	NL523W01-004
7662	.625 (15.9)	.375 (9.5)	6-32	.250 (6.4)	NL523W01-005
7663	.625 (15.9)	.500 (12.7)	8-32	.187 (4.7)	NL523W02-005
7664	.750 (19.1)	.375 (9.5)	6-32	.250 (6.4)	NL523W01-006
7665	.750 (19.1)	.500 (12.7)	8-32	.250 (6.4)	NL523W02-006
7666	1.000 (25.4)	.375 (9.5)	6-32	.375 (9.5)	NL523W01-008
7667	1.000 (25.4)	.500 (12.7)	8-32	.375 (9.5)	NL523W02-008
7668	1.000 (25.4)	.750 (19.1)	10-32	.375 (9.5)	NL523W03-008
7669	1.250 (31.8)	.375 (9.5)	6-32	.375 (9.5)	NL523W01-010
7670	1.250 (31.8)	.500 (12.7)	8-32	.375 (9.5)	NL523W02-010
7671	1.250 (31.8)	1.000 (25.4)	1/4 - 20	.437 (11.1)	NL523W04-010
7672	1.500 (38.1)	.375 (9.5)	6-32	.375 (9.5)	NL523W01-012
7673	1.500 (38.1)	.500 (12.7)	8-32	.375 (9.5)	NL523W02-012
7674	1.500 (38.1)	.750 (19.1)	10-32	.375 (9.5)	NL523W03-012
7675	1.500 (38.1)	1.000 (25.4)	1/4 - 20	.500 (12.7)	NL523W04-012
7676	2.000 (50.8)	.375 (9.5)	6-32	.375 (9.5)	NL523W01-016
7677	2.000 (50.8)	.500 (12.7)	8-32	.375 (9.5)	NL523W02-016
7678	2.000 (50.8)	.750 (19.1)	10-32	.375 (9.5)	NL523W03-016

NYLON RETAINING SPACERS

Similar to our standard spacers, but with a specially configured I.D. designed to grip the outside of the screw shank. The spacer slides on the screw shank, but is retained on the screw. For use in applications requiring pre-assembly of the screw and spacer, to reduce final assembly cost.

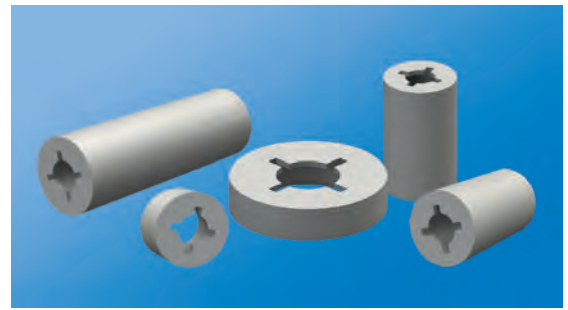
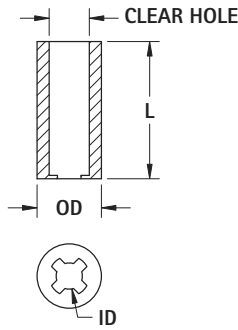

CAT. NO.	.156 (3.9) Clear Hole for #4 Screw		
	LENGTH	O.D.	I.D.
2341	.125 (3.2)		
2342	.250 (6.4)		
2343	.375 (9.5)		
2344	.500 (12.7)	.250 (6.4)	.102 (2.6)
2345	.625 (15.9)		
2346	.750 (19.1)		
2347	.875 (22.2)		
2348	1.00 (25.4)		

CAT. NO.	.198 (5.0) Clear Hole for #6 Screw		
	LENGTH	O.D.	I.D.
2361	.125 (3.2)		
2362	.250 (6.4)		
2363	.375 (9.5)		
2364	.500 (12.7)	.312 (7.9)	.128 (3.3)
2365	.625 (15.9)		
2366	.750 (19.1)		
2367	.875 (22.2)		
2368	1.00 (25.4)		

CAT. NO.	.240 (6.1) Clear Hole for #8 Screw		
	LENGTH	O.D.	I.D.
2381	.125 (3.2)		
2382	.250 (6.4)		
2383	.375 (9.5)		
2384	.500 (12.7)	.375 (9.5)	.152 (3.8)
2385	.625 (15.9)		
2386	.750 (19.1)		
2387	.875 (22.2)		
2388	1.00 (25.4)		

CAT. NO.	.277 (7.0) Clear Hole for #10 Screw		
	LENGTH	O.D.	I.D.
2391	.125 (3.2)		
2392	.250 (6.4)		
2393	.375 (9.5)		
2394	.500 (12.7)	.500 (12.7)	.177 (4.5)
2395	.625 (15.9)		
2396	.750 (19.1)		
2397	.875 (22.2)		
2398	1.00 (25.4)		

HINGED STANDOFFS



- Applications unlimited
- Time saving
- Space saving
- Interconnect circuits or services without danger of shorting

MATERIAL:
Brass, ASTM-B16. Zinc Plate and Yellow Chromate



FEMALE/FEMALE



CAT. NO.	L LENGTH	U	P	D DIAMETER	T THREAD
351	.750 (19.1)	.172 (4.4)	.375 (9.5)	.187 (4.7)	4-40
352	1.000 (25.4)	.250 (6.4)	.625 (15.9)		
330	1.250 (31.8)	.250 (6.4)	.625 (15.9)		
353	.750 (19.1)	.172 (4.4)	.375 (9.5)	.250 (6.4)	6-32
354	1.000 (25.4)	.250 (6.4)	.625 (15.9)		
331	1.250 (31.8)	.250 (6.4)	.625 (15.9)		
355	.750 (19.1)	.172 (4.4)	.375 (9.5)	.250 (6.4)	8-32
356	1.000 (25.4)	.250 (6.4)	.625 (15.9)		
332	1.250 (31.8)	.250 (6.4)	.625 (15.9)		

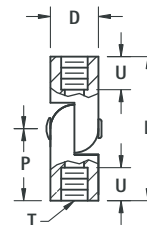

MALE/FEMALE



CAT. NO.	L LENGTH	S	U	D DIAMETER	T THREAD
333	.625 (15.9)	.250 (6.4)	.172 (4.4)	.187 (4.7)	4-40
334	.875 (22.2)	.250 (6.4)	.250 (6.4)		
335	.625 (15.9)	.312 (7.9)	.172 (4.4)	.250 (6.4)	6-32
336	.875 (22.2)	.312 (7.9)	.250 (6.4)		
337	.625 (15.9)	.312 (7.9)	.172 (4.4)		
338	.875 (22.2)	.312 (7.9)	.250 (6.4)	.250 (6.4)	8-32

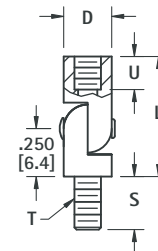

MALE/MALE



CAT. NO.	L LENGTH	S	P	D DIAMETER	T THREAD
357	.500 (12.2)	.250 (6.4)	.250 (6.4)	.187 (4.7)	4-40
358	.500 (12.2)	.312 (7.9)	.250 (6.4)	.250 (6.4)	6-32
359	.500 (12.2)	.312 (7.9)	.250 (6.4)	.250 (6.4)	8-32

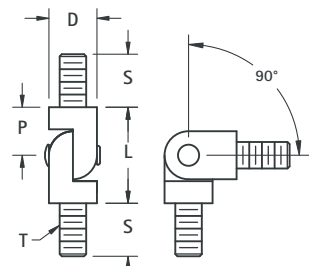

INSULATED PC SPACER/SUPPORTS

- Board will be electrically insulated, eliminates need for insulating washers
- No tool required for installation
- Easy snap-in assembly
- One pieces design eliminates the need for additional screws and nuts
- Fits snug onto board
- Accommodates varying board thicknesses
- Flame retardant

.156 (4.0)

SLIMLINE TENSION-FIT



.187 (4.8)

- One end permanently attaches to .070 (1.78) max. thick chassis
- Other end tension fits to .062 (1.57) max. thick PC board
- Board is easily releasable for repairs or upgrades
- Low insertion force

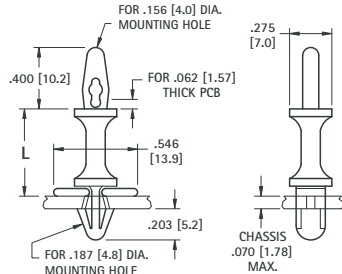

CAT. NO.	L LENGTH
1927A	.250 (6.4)
1928A	.375 (9.5)
1929A	.500 (12.7)
1930A	.625 (15.9)
1931A	.750 (19.1)
1932A	.875 (22.2)
1933A	1.000 (25.4)

MATERIAL: Nylon 6/6, UL Rated 94V-0

.156 (4.0)

SLIMLINE LOCK-IN



.187 (4.8)

- One end permanently attaches to .070 (1.78) max. thick chassis
- Other end permanently attaches to .062 (1.57) max. thick PC board
- Low insertion force
- Small footprint frees up board space.

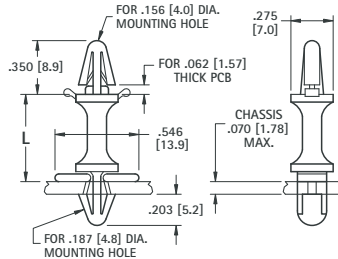

CAT. NO.	L LENGTH
1927B	.250 (6.4)
1928B	.375 (9.5)
1929B	.500 (12.7)
1930B	.625 (15.9)
1931B	.750 (19.1)
1932B	.875 (22.2)
1933B	1.000 (25.4)

MATERIAL: Nylon 6/6, UL Rated 94V-0

.156 (4.0)

STURDY TENSION-FIT



.187 (4.8)

- One end permanently attaches to .031(.79) - .078 (2.0) thick chassis
- Other end tension fits to .062 (1.57) max thick PC board
- Board is easily releasable for repairs or upgrades
- Sturdy support due to high contact area

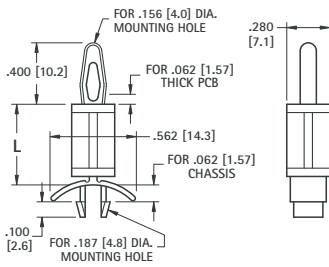

CAT. NO.	L LENGTH
8800	.187 (4.7)
8801	.250 (6.4)
8802	.375 (9.5)
8803	.500 (12.7)
8804	.625 (15.9)
8805	.750 (19.1)
8806	.875 (22.2)

MATERIAL: Nylon 6/6, UL Rated 94V-0

.156 (4.0)

STURDY LOCK-IN



.156 (4.0)

- Both ends permanently attaches to .031 (.79) - .078 (2.0) thick chassis or board
- Sturdy support due to high contact area

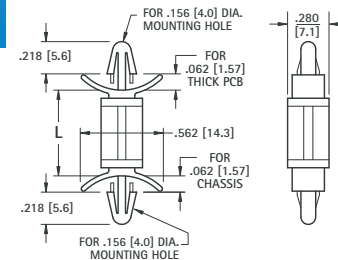

CAT. NO.	L LENGTH
8815	.187 (4.7)
8816	.250 (6.4)
8817	.375 (9.5)
8818	.500 (12.7)
8819	.625 (15.9)
8820	.750 (19.1)
8821	.875 (22.2)

MATERIAL: Nylon 6/6, UL Rated 94V-0

.156 (4.0)

STURDY LOCK-IN RELEASE



.187 (4.8)

- Locks onto .062 (1.57) thick PC board
- Board is positively locked until manually released
- Board is easily releasable for repairs or upgrades
- Sturdy support due to high contact area with chassis

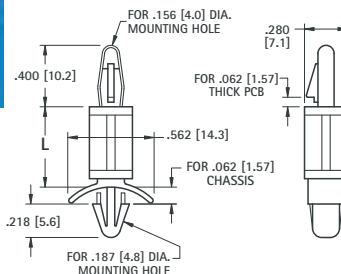

CAT. NO.	L LENGTH
8807	.187 (4.7)
8808	.250 (6.4)
8809	.375 (9.5)
8810	.500 (12.7)
8811	.625 (15.9)
8812	.750 (19.1)
8813	.875 (22.2)
8814	1.000 (25.4)

MATERIAL: Nylon 6/6, UL Rated 94V-0

.125 (3.2)

SLIMLINE LOCK-IN RELEASE



.125 (3.2)

- Locks onto .062 (1.57) thick PC board
- Board is positively locked until manually unlocked
- Board is easily releasable for repairs or upgrades
- Compact design uses smaller mounting holes

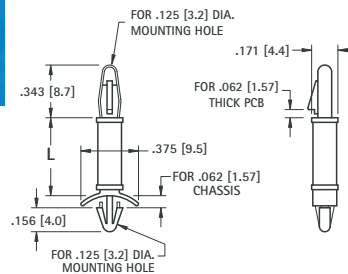

CAT. NO.	L LENGTH
8871	.187 (4.7)
8872	.250 (6.4)
8873	.375 (9.5)
8874	.500 (12.7)
8875	.625 (15.9)

MATERIAL: Nylon 6/6, UL Rated 94V-0

INSULATED PC SPACERS/SUPPORTS

- Board will be electrically insulated, eliminates need for insulating washers
- Easy snap-in assembly
- No tool required for installation
- Designed for .062 (1.57) thick boards

- One piece design eliminates the need for additional screws and nuts
- Slim design frees up board space

.125 (3.2)

TENSION-FIT



- One end permanently attaches to chassis
- Other end secures board with tension fit.
- Board easily releasable for repairs or upgrades

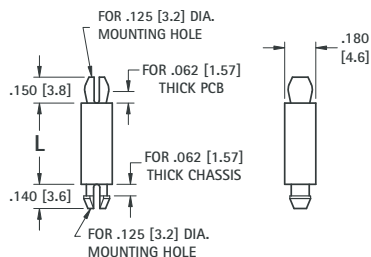

CAT. NO.	L LENGTH
8879	.125 (3.2)
8880	.187 (4.7)
8881	.250 (6.4)
8882	.375 (9.5)
8883	.500 (12.7)
8884	.625 (15.9)
8885	.750 (19.1)
8886	.875 (22.2)
8887	1.000 (25.4)

MATERIAL: Nylon 6/6, UL Rated 94V-0

.100 (2.6)

EASY LOCK-IN



- Both ends permanently attach to chassis and board
- Teardrop style mounting end eases assembly
- Low protrusion above board and under chassis

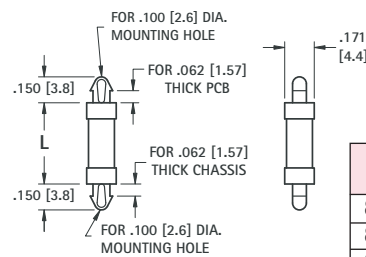

CAT. NO.	L LENGTH
8888	.125 (3.2)
8889	.187 (4.7)
8890	.250 (6.4)
8891	.375 (9.5)
8892	.500 (12.7)
8893	.625 (15.9)

MATERIAL: Nylon 6/6, UL Rated 94V-0

.125 (3.2)

LOCK-IN



- Both ends permanently attach to chassis and board
- Secure mounting end design allows for taller spacing

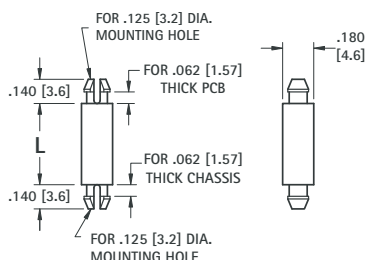

CAT. NO.	L LENGTH
9018	.125 (3.2)
9019	.187 (4.7)
9020	.250 (6.4)
9021	.375 (9.5)
9022	.500 (12.7)
9023	.625 (15.9)
9024	.750 (19.1)
9025	.875 (22.2)
9026	1.000 (25.4)

MATERIAL: Nylon 6/6, UL Rated 94V-0

.156 (4.0)

THREADED



THREAD

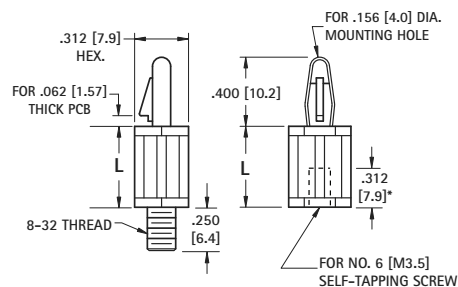

- One end attaches to chassis with screw or tapped hole
- Other end snap locks onto .062 (1.6) board
- Board is releasable for easy repair or upgrades

MALE CAT. NO.	L LENGTH	FEMALE CAT. NO.
9048	.250 (6.4)	9041
9049	.375 (9.5)	9042
9050	.500 (12.7)	9043
9051	.625 (15.9)	9044
9052	.750 (19.1)	9045
9053	.875 (22.2)	9046
9054	1.000 (25.4)	9047

MATERIAL: Nylon 6/6, UL Rated 94V-0

THRU HOLE SPACERS

One end locks into panel. Clear hole designs for #4, #6 or #8 screw.



- Base has larger surface area. Will not deform under heavy pre-load.

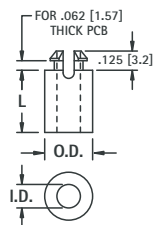

CAT. NO.	L LENGTH	Outside Diameter	Inside Diameter	Mounting Hole	Screw Size
9027	.125 (3.2)				
9028	.187 (4.7)				
9029	.250 (6.4)	.260 (6.6)	.125 (3.2)	.187 (4.7)	#4
9030	.375 (9.5)				
9031	.500 (12.7)				
9032	.625 (15.9)				
9033	.250 (6.4)				
9034	.375 (9.5)	.281 (7.1)	.153 (3.9)	.234 (5.9)	#6
9035	.500 (12.7)				
9036	.625 (15.9)				
9037	.250 (6.4)				
9038	.375 (9.5)	.281 (7.1)	.169 (4.3)	.234 (5.9)	#8
9039	.500 (12.7)				
9040	.625 (15.9)				

MATERIAL: Nylon 6/6, UL Rated 94V-0

STACKING SPACERS

One end locks into panel. Clear hole designs for #4, #6 or #8 screw.



- Spacers can be stacked for multiple level PC board applications
- Self-aligning

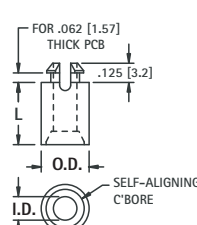

CAT. NO.	L LENGTH	Outside Diameter	Inside Diameter	Mounting Hole	Screw Size
8829	.125 (3.2)				
8830	.187 (4.7)				
8831	.250 (6.4)	.260 (6.6)	.125 (3.2)	.187 (4.7)	#4
8832	.375 (9.5)				
8833	.500 (12.7)				
8834	.625 (15.9)				
8835	.250 (6.4)				
8836	.375 (9.5)	.312 (7.9)	.153 (3.9)	.234 (5.9)	#6
8837	.500 (12.7)				
8838	.625 (15.9)				
8839	.250 (6.4)				
8840	.375 (9.5)	.312 (7.9)	.169 (4.3)	.234 (5.9)	#8
8841	.500 (12.7)				
8842	.625 (15.9)				

INSULATED PC SPACERS/SUPPORTS

- Board will be electrically insulated, eliminates need for insulating washers
- No tool required for installation • Easy snap-in assembly

ADHESIVE LOCK-IN RELEASE SUPPORTS

- One end attaches to chassis with self adhesive pads
- No drilling to chassis required leaving outside in perfect condition
- Other end snap into .062 (1.57) board
- Board is easily releasable for repair or upgrade

.156 (4.0)



STURDY SUPPORT

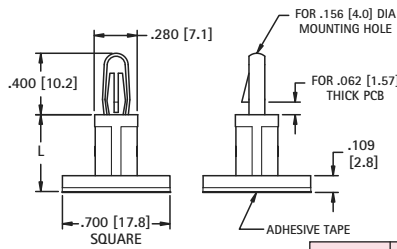

CAT. NO.	L LENGTH
9080	.187 (4.7)
9081	.250 (6.4)
9082	.375 (9.5)
9083	.500 (12.7)
9084	.625 (15.9)

Material: Nylon 6/6, UL Rated 94V-0

.125 (3.2)



SLIMLINE SUPPORT

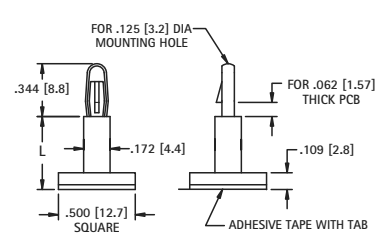

CAT. NO.	L LENGTH
9070	.187 (4.7)
9071	.250 (6.4)
9072	.375 (9.5)
9073	.500 (12.7)
9074	.625 (15.9)

Material: Nylon 6/6, UL Rated 94V-0

PC SPACER SUPPORTS

- One end locks into chassis • Other end supports the PC Board
- Ideal for mid supports of large boards
- Simplifies assembly for multiple support applications • Reduces the amount of holes required in PC board

STURDY SUPPORT



- One end permanently attaches to .062 (1.57) chassis
- Accommodates varying board thicknesses
- Sturdy support due to large contact area

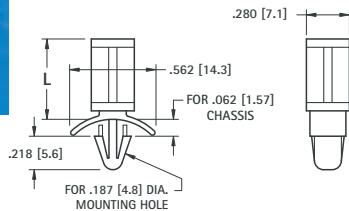

CAT. NO.	L LENGTH
8822	.187 (4.7)
8823	.250 (6.4)
8824	.375 (9.5)
8825	.500 (12.7)
8826	.625 (15.9)
8827	.750 (19.1)
8828	.875 (22.2)

Material: Nylon 6/6, UL Rated 94V-0

SLIMLINE SUPPORT



- One end permanently attaches to .062 (1.57) chassis
- Low protrusion under chassis
- Small diameter frees up space on PC board

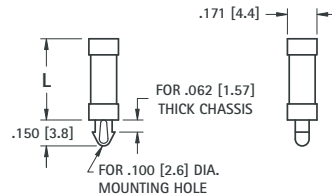

CAT. NO.	L LENGTH
9055	.125 (3.2)
9056	.187 (4.7)
9057	.250 (6.4)
9058	.375 (9.5)
9059	.500 (12.7)
9060	.625 (15.9)

Material: Nylon 6/6, UL Rated 94V-0

REVERSE CHASSIS MOUNT SUPPORTS

- Permanently attaches to .059 (1.51) - .065 (1.65) thick case from outside
- Provides flat clean cosmetic appearance • Ideal for low clearance applications or for mounting directly to case walls

.156 (4.0)



LOCK-IN RELEASE

- End locks onto .062 (1.57) PC board
- Board is positively locked until manually released
- Board is easily releasable for repairs or upgrades

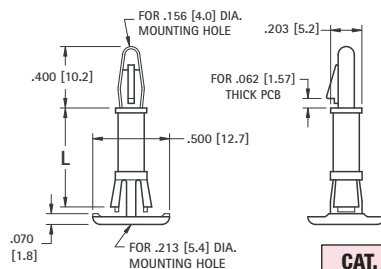

CAT. NO.	L LENGTH
9061	.250 (6.4)
9062	.375 (9.5)
9063	.500 (12.7)
9064	.625 (15.9)

Material: Nylon 6/6, UL Rated 94V-0

.125 (3.2)



SLIMLINE LOCK-IN

- End permanently attaches to .062 (1.57) PC board
- Small footprint frees up PC board space

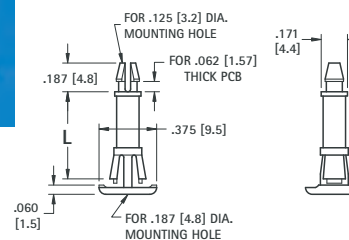

CAT. NO.	L LENGTH
9065	.250 (6.4)
9066	.375 (9.5)
9067	.500 (12.7)
9068	.625 (15.9)

Material: Nylon 6/6, UL Rated 94V-0

INSULATED PC SPACERS/SUPPORTS

SPACERS/STANDOFF ORGANIZER KITS



Maintain a neat complete inventory of the most frequently used spacers and standoffs in day-to-day operations. Choice of 14 different kits of the most popular spacers and standoffs. An assortment of various sizes and styles in Brass, Aluminum and Nylon with tapped or thru hole. Supplied with clear draw cabinet labeled for easy identification.

Kits combine the most frequently used spacers or standoffs for stacking and a multi-stacking prototyping.

SPACER ASSORTMENT KITS



Assortment of 1500 pieces in .250, .375, .500, .750 and 1.000 lengths, with clearance holes for #4, #6 and #8.

100 pieces of each size. Complete with cabinet.

CAT. NO.	KIT SUPPLIED WITH
SPR-13	Brass Nickel Plated Spacers
SPR-34	Aluminum Spacers with Iridite Finish
SPR-8	Nylon 6/6 Spacers

CLEAR HOLE SPACER KITS



Assortment of 400 total spacers: Brass, Aluminum, Nylon, Rolled Aluminum, with lengths of .250, .500, .750 and 1.000.

25 pieces of each size. Complete with cabinet.

CAT. NO.	KIT SUPPLIED WITH
SCR-4	#4 Clear Hole Spacers
SCR-6	#6 Clear Hole Spacers
SCH-8	#8 Clear Hole Spacers

HEX STANDOFF KITS



Assortment of 400 total standoffs: Female-Female standoffs and Male-Female standoffs both Aluminum and Nylon, with lengths of .250, .500, .750 and 1.000.

25 pieces of each size. Complete with cabinet and 25 machine screws with matching thread.

CAT. NO.	KIT SUPPLIED WITH
STR-440	4-40 Threaded Standoffs
STR-632	6-32 Threaded Standoffs
STR-832	8-32 Threaded Standoffs

THREADED STANDOFF KITS



Assortment of 425 total pieces. Female-Female standoffs and Male-Female standoffs both aluminum and nylon, with lengths of 10mm, 12mm, 15mm and 20mm.

25 pieces of each size. Complete with cabinet and 25 machine screws with matching threads.

CAT. NO.	KIT SUPPLIED WITH
STR-M3	M3 Threaded Standoffs
STR-M4	M4 Threaded Standoffs

FEMALE-FEMALE STANDOFF KITS



Assortment of 1500 pieces in .250, .375, .500, .750 and 1.000 lengths, with thread sizes of 4-40, 6-32, and 8-32.

100 pieces of each size. Complete with cabinet.

CAT. NO.	KIT SUPPLIED WITH
STR-15	Round Brass Zinc Plated Standoffs
STR-35	Round Aluminum Standoffs with Iridite Finish
STH-14	Hex Brass Zinc Plated Standoffs
STH-22	Hex Aluminum Standoff with Iridite Finish

MALE-FEMALE STANDOFF KITS



Brass kit is an assortment of 750 pieces of .500, .750, 1.000, and 1.500 long standoffs with 4-40, 6-32 and 8-32 thread.

Complete with cabinet.

Stainless kit is an assortment of 250 pieces of .250, .500, .750, and 1.000 long standoffs with 4-40, 6-32 and 8-32 thread.

Complete with cabinet and 25 pieces of each screw size.

CAT. NO.	KIT SUPPLIED WITH
STH-19	Brass-Nickel Plate Standoffs
STH-20	Stainless Steel Standoffs

SELF-RETAINING SPACER ENGINEERING DESIGN KIT



Assortment of 400 total pieces per kit of Self Retaining Round Nylon Spacers. Lengths of .125, .250, .500 and .750

25 pieces of each size/style.
Complete with cabinet.

CAT. NO.	KIT SUPPLIED WITH
SCR-10	#4, #6, #8 & #10 Spacers

CIRCUIT BOARD SPACER/SUPPORT ENGINEERING DESIGN KITS



Assortment of 400 total pieces per kit of a variety of Circuit Board Hardware in .125, .250, .375 and .500 lengths in Nylon 6/6 material.

25 pieces of each size/style.
Complete with cabinet.

CAT. NO.	KIT SUPPLIED WITH
CBH-1	SlimLine Products - Tension Fit; Lock-In, Easy Lock and Single Sided
CBH-2	Lock-In Products - Tension Fit; Lock-In, Easy Lock and Single Sided
CBH-3	Stacking Products - Thru-Hole and Self Aligning

THIS DOCUMENT IS THE PROPERTY OF KEYSTONE ELECTRONICS CORP. AND SHALL NOT BE REPRODUCED, DISTRIBUTED OR USED AS A BASIS FOR MANUFACTURE WITHOUT PRIOR WRITTEN PERMISSION FROM KEYSTONE ELECTRONICS CORP.

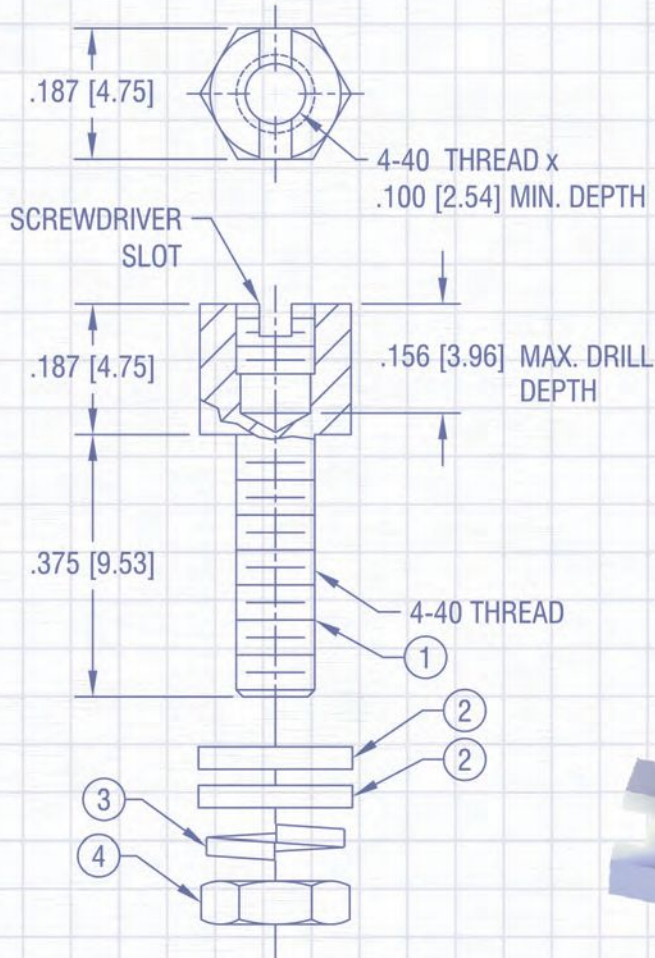
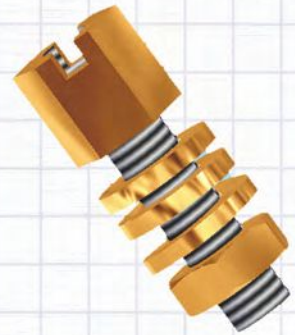

PANEL HARDWARE

Our diverse selection of panel hardware is second to none in the marketplace. Our Handles, Screws, Knobs, Fan Guards and LED lens and mounting spacers provides the right solution for a variety of applications, including:

- Rack Mounted Equipment
- Carrying Cases
- Low Friction Assemblies
- "D" Subminiature connector Hardware
- Instrumentation Panels and Gauges
- Environments where mounting hardware is subject to loss
- For protection from damage or debris
- To dress up chassis access panels, racks or controls

Our quality system is ISO 9001:2008 certified. Our products are in compliance with the RoHS and REACH directives. We provide 3D modeling, CAD and other application-engineering support for modifications, special designs or assembly requirements to assist you in choosing the right Keystone product for your application.

DATE	DESCRIPTION	REV.

NUMERICAL INDEX

CAT. NO.	22 – 573	PAGE NO.	CAT. NO.	574 – 1028	PAGE NO.	CAT. NO.	1029 – 1425	PAGE NO.
22 thru 48		134	574		102	1029		18
50		8	575		107	1029C		18
51 thru 52		9	576		102	1029LC		18
53		8	577		103	1030 thru 1041		59
54		9	580 thru 583		102	1042 thru 1043		17
55 thru 57		8	584 thru 589		103	1045 thru 1046		59
58 thru 60		10	590 thru 591		9	1048 thru 1049		17
61 thru 66		11	593 thru 594		30	1050 thru 1051		20
68		29	595 thru 597		9	1052 thru 1053		5
69 thru 71		11	598 thru 599		102	1056		2
72		29	603 thru 609		142	1059 thru 1064		4
78 thru 80		11	611 thru 612		120	1065 thru 1067		3
81		28	613		121	1068		5
82		9	614		120	1069		2
83		29	615		121	1071 thru 1073		5
84		28	616 thru 617		120	1081 thru 1082		4
85		29	618 thru 620		121	1083 thru 1091		5
86 thru 89		10	621		120	1093 thru 1094		4
90 thru 91		11	628 thru 629		9	1103		20
92		9	630		121	1139 thru 1199		24
93 thru 95		11	631 thru 632		120	1200		123
96		29	633		121	1201 thru 1209		66
97 thru 98		11	634		120	1210		123
99 thru 100		10	635 thru 636		30	1211 thru 1213		52
101 thru 103		3	637		9	1215		67
104 thru 105		5	652 thru 659		106	1216		52
106		3	680		58	1217		67
107		5	700 thru 705		85	1218 thru 1219		101
108		18	708		120	1220 thru 1222		54
108-2		13	715 thru 716		85	1223 thru 1226		123
108C		18	717 thru 729		130	1227 thru 1229		54
109-2		13	730 thru 778		129	1230 thru 1231		123
109-3		13	779		74	1232		67
131 thru 132		20	780 thru 785		130	1233 thru 1235		54
137 thru 140		22	789 thru 799		74	1236 thru 1238		123
146 thru 153		21	800 thru 868		143	1240 thru 1242		54
154 thru 156		22	875 thru 898		74	1247 thru 1248		67
158		21	900 thru 902		103	1249 thru 1250		59
169 thru 201		22	903 thru 910		58	1252		56
202		12	911		102	1254		142
203-P		31	913 thru 918		58	1256 thru 1263		54
204		12	920 thru 923		94	1264		56
205		22	924		95	1265 thru 1266		53
206 thru 208		10	925		94	1267		52
209 thru 210		12	926		95	1269 thru 1271		54
211		10	927 thru 930		97	1272 thru 1273		67
217 thru 222		11	931 thru 932		94	1280		54
223 thru 224		20	933 thru 935		95	1281 thru 1282		53
227		29	936 thru 938		103	1283 thru 1284		66
228		12	940 thru 941		95	1285 thru 1286		52
230-1		13	945 thru 957		96	1287		53
232 thru 237		28	967 thru 968		29	1288		52
238		12	970 thru 973		102	1289		53
261 thru 272		30	1005 thru 1008		54	1290 thru 1291		31
288 thru 296		12	1010 thru 1011		20	1292		53
301		5	1012		19	1293		66
303-P		31	1012C		19	1294 thru 1295		31
330 thru 338		75	1013 thru 1015		18	1298 thru 1299		66
340 thru 344		132	1016		19	1301 thru 1326		135
345 thru 349		131	1017		18	1345		57
351 thru 359		75	1017-1		13	1352 thru 1365		101
361 thru 375		74	1018 thru 1018C		19	1366 thru 1369		100
376 thru 396		71	1019		18	1370 thru 1371		101
397 thru 438		74	1020		19	1372 thru 1373		100
451 thru 452		107	1020C		19	1375 thru 1377		101
453 thru 459		74	1021		18	1378 thru 1379		100
468 thru 471		71	1021-1		13	1380 thru 1400		101
476		107	1022		19	1401		100
480 thru 496		87	1022C		19	1402		101
498 thru 504		2	1023		18	1404		100
510 thru 526		87	1024		19	1405		101
540 thru 548		86	1024C		19	1406 thru 1408		100
550		8	1025		5	1411 thru 1420		98
552		106	1025-7		5	1421		100
553 thru 557		8	1026		3	1422		101
561 thru 567		102	1027		5	1424		100
571 thru 573		103	1028 thru 1028C		18	1425		101

CAT. NO.	1426 – 1639	PAGE NO.	CAT. NO.	1640– 3450	PAGE NO.	CAT. NO.	3451 – 4689	PAGE NO.
1426 thru 1428		100	1640 thru 1641		99	3457 thru 3477		74
1430		101	1642 thru 1643		71	3478 thru 3500		71
1431 thru 1432		98	1644 thru 1646		70	3501 thru 3509		99
1434		99	1650 thru 1655		73	3510 thru 3511		45
1435 thru 1436		98	1656 thru 1657		71	3512		44
1437 thru 1438		99	1658 thru 1659		98	3513 thru 3516		45
1439		98	1662 thru 1672		74	3517 thru 3521		44
1441 thru 1447		101	1673 thru 1689		99	3522		39
1448 thru 1449		84	1692		71	3523		42
1450 thru 1451		71	1693 thru 1699		98	3525		55
1453		84	1700 thru 1706		84	3526 thru 3527		42
1454		74	1707		135	3528		55
1455		101	1708 thru 1710		83	3529 thru 3533		45
1456		84	1713 thru 1726		135	3534		55
1457		74	1731 thru 1796		73	3535		45
1458 thru 1459		84	1797 thru 1904		71	3536 thru 3543		43
1460 thru 1463		101	1909 thru 1920		74	3544		40
1464 thru 1467		84	1921 thru 1923		71	3545 thru 3548		55
1468 thru 1471		98	1924 thru 1925		74	3549		40
1472		84	1927 thru 1933		76	3550		39
1473		99	1934 thru 1942		74	3551		55
1474 thru 1475		71	1944 thru 1966		70	3552 thru 3554		43
1476		109	1967 thru 2001		100	3555		38
1476		131	2002 thru 2005		54	3556		43
1477		109	2025 thru 2031		71	3557		39
1477		131	2032 thru 2036		74	3558 thru 3560		38
1478		98	2037 thru 2053		85	3561 thru 3562		44
1479		99	2060 thru 2073		82	3563 thru 3564		40
1480 thru 1484		74	2087 thru 2099		70	3565 thru 3566		44
1485		131	2103		20	3567		45
1486		99	2119 thru 2131		70	3568		40
1487		101	2139 thru 2140		24	3569		41
1488		99	2149 thru 2161		70	3570		45
1490 thru 1494		74	2162 thru 2176		24	3571 thru 3572		55
1495		123	2180 thru 2181		70	3573		39
1496 thru 1497		99	2182 thru 2199		24	3575		55
1498 thru 1500		123	2201 thru 2221		71	3576		43
1502 thru 1503		138	2222 thru 2233		21	3576C		43
1507		139	2238 thru 2243		28	3577 thru 3578		55
1508		138	2244 thru 2253		131	3586 thru 3588		41
1509 thru 1511		139	2260 thru 2274		73	3590 thru 3592		98
1514		138	2284 thru 2293		131	3593 thru 3595		99
1515 thru 1519		139	2314		74	3621 thru 3622		44
1520		138	2341 thru 2398		75	4000 thru 4004		58
1525 thru 1526		139	2400 thru 2420		83	4005		54
1527 thru 1532		138	2421 thru 2455		84	4056 thru 4060		142
1533		139	2460 thru 2473		26	4091 thru 4094		108
1535 thru 1537		67	2474 thru 2476		27	4095		54
1540 thru 1545		139	2477 thru 2482		26	4096 thru 4109		108
1546		73	2484		27	4116 thru 4120		142
1547 thru 1548		71	2485 thru 2486		26	4147 thru 4196		143
1556		121	2487 thru 2490		27	4198 thru 4199		108
1557 thru 1559		139	2500 thru 2508		83	4245		42
1560 thru 1561		73	2915		9	4245C		43
1562		139	2981 thru 2983		7	4246 thru 4247		45
1563		138	2988 thru 2989		6	4250		42
1564 thru 1571		121	2990 thru 2993		7	4258 thru 4269		74
1572 thru 1573		138	2994 thru 2999		6	4325 thru 4326		121
1575 thru 1583		139	3000 thru 3013		7	4332 thru 4334		120
1587		138	3020 thru 3025		4	4335 thru 4337		121
1589 thru 1591		73	3026 thru 3029		7	4341 thru 4343		132
1592		139	3030 thru 3031		6	4401 thru 4405		142
1593 thru 1595		138	3032 thru 3044		7	4469 thru 4474		56
1596		73	3049		131	4513 thru 4516		111
1598		138	3050		6	4525 thru 4527		42
1601		104	3051 thru 3069		132	4527C		42
1603		98	3070 thru 3074		4	4590 thru 4600		110
1604 thru 1605		73	3075 thru 3077		134	4601 thru 4609		111
1606 thru 1607		98	3078 thru 3092		7	4616 thru 4617		110
1608 thru 1612		73	3096 thru 3098		6	4618 thru 4620		111
1613		139	3101 thru 3110		132	4626		110
1614 thru 1619		98	3111 thru 3228		131	4628		42
1620 thru 1625		73	3229 thru 3241		132	4628C		42
1626		98	3347 thru 3373		131	4632 thru 4634		110
1627 thru 1630		73	3381 thru 3391		134	4636 thru 4683		109
1633		139	3402 thru 3438		74	4684		111
1635 thru 1639		71	3440 thru 3450		134	4687 thru 4689		132

NUMERICAL INDEX

CAT. NO.	4690 – 7696	PAGE NO.	CAT. NO.	7697 – 9920	PAGE NO.	CAT. NO.	9920 – TL-22	PAGE NO.
4690		109	7697		63	9920		64
4691 thru 4693		131	7697-SEMS		64	11001 thru 11016		105
4694		132	7698		65	11065 thru 11076		136
4696		109	7699		63	11100 thru 11116		137
4698		132	7699-SEMS		64	11150 thru 11160		136
4699 thru 4700		131	7700 thru 7702		62	11216 thru 11218		136
4701 thru 4702		132	7700-SEMS thru 7702-SEMS		64	11250 thru 11251		136
4703		131	7710 thru 7720		74	11300 thru 11312		136
4704		58	7760 thru 7775		63	11320 thru 11322		136
4704		109	7775-SEMS		64	11350 thru 11362		137
4705		132	7778		63	11362-5		131
4706		111	7778-SEMS		64	11363 thru 11513		137
4707 thru 4711		132	7779 thru 7783		62	15021 thru 15099		140
4712		109	7784 thru 7789		63	15101 thru 15130		142
4713 thru 4716		132	7790		65	15221 thru 15299		140
4724 thru 4730		109	7791		63	15301 thru 15330		142
4732 thru 4734		111	7792 thru 7800		65	15401 thru 15545		141
4799 thru 4841		70	7802 thru 7806		54	24283 thru 24306		72
4850 thru 4870		73	7807 thru 7808		65	24307 thru 24330		72
4900		52	7812 thru 7836		54	24331 thru 24354		72
4901 thru 4902		53	8090 thru 8096		127	24380 thru 24418		72
4903 thru 4907		52	8100 thru 8173		126	24420 thru 24458		72
4908		53	8174		63	24460 thru 24498		72
4909		52	8189 thru 8195		62	25501 thru 25515		72
4910 thru 4914		53	8196 thru 8199		63	25521 thru 25535		72
4950 thru 4954		59	8189-SEMS thru 8199-SEMS		64	29301 thru 29328		72
4966		53	8200 thru 8271		57	29331 thru 29358		72
5000 thru 5014		60	8272 thru 8300		56	CBH		79
5015 thru 5019		61	8309 thru 8310		90	MS27249-1B1 thru -5B5		141
5020 thru 5021		60	8311 thru 8342		91	MS27249-1E1 thru 5E5		141
5029		61	8351 thru 8356		86	PC104		70
5033 thru 5048		60	8400 thru 8440		70	SCR		79
5058 thru 5065		73	8440 thru 8442		71	SPR		79
5070 thru 5083		123	8447 thru 8457		89	STH		79
5115 thru 5129		60	8458 thru 8467		88	STR		79
5201		15	8470 thru 8496		128	TL-1 thru TL-2		138
5202 thru 5204		14	8554 thru 8569		85	TL-3 thru TL-4		139
5205 thru 5209		13	8600 thru 8613		128	TL-5 thru TL-8		138
5210 thru 5212		15	8615 thru 8617		129	TL-9		139
5213 thru 5214		14	8620 thru 8644		122	TL-11		123
5217 thru 5223		15	8650 thru 8692		90	TL-12		139
5224 thru 5228		14	8700 thru 8711		83	TL-19 thru TL-22		73
5230 thru 5231		8	8712 thru 8733		70			
5240 thru 5253		16	8737		66			
5330 thru 5331		8	8799		70			
5799		70	8800 thru 8821		76			
6000 thru 6035		104	8822 thru 8828		78			
6036 thru 6071		105	8829 thru 8842		77			
6072 thru 6075		106	8843 thru 8851		72			
6076 thru 6077		107	8860 thru 8870		127			
6078 thru 6085		106	8871 thru 8875		76			
6090 thru 6096		107	8879 thru 8893		77			
6097		104	8894 thru 8899		122			
6799		70	8900 thru 8931		91			
7004 thru 7024		108	9018 thru 9054		77			
7030 thru 7061		91	9055 thru 9084		78			
7140 thru 7181		87	9100 thru 9123		87			
7186 thru 7188		86	9190 thru 9191		133			
7192 thru 7194		87	9200 thru 9204		114			
7196		86	9205 thru 9231		115			
7200 thru 7225		70	9200-1 thru 9200-5		116			
7228 thru 7235		82	9200-6 thru 9200-10		117			
7235-1 thru 7235-2		131	9200-11		116			
7236 thru 7299		82	9200-12 thru 900-13		117			
7311 thru 7340		58	9200-14		116			
7351 thru 7382		91	9200-15		117			
7600 thru 7611		128	9200-16		116			
7620 thru 7640		127	9200-17		117			
7661		65	9200-19		116			
7661		74	9201-1 thru 9204-1		117			
7662		65	9207-1 thru 9231-1		116			
7662 thru 7678		74	9300 thru 9357		133			
7680 thru 7688		132	9400 thru 9457		133			
7689		65	9500 thru 9581		133			
7690 thru 7693		62	9600 thru 9604		132			
7690-SEMS thru 7693-SEMS		64	9605 thru 9608		133			
7695 thru 7696		65	9900 thru 9911		87			